

# BVL-L-TERMINAL

## VLD - for DC traction / Accesories for VLD

L-shaped connection bracket

L shape terminal for BVL-50-xxx or BVL-100-xxx

- terminal for BVL series
- montage on flat surfaces (steel construction, flat wires etc.)
- easy montage
- improves cooling of BVL body
- assembly material included (for BVL body + terminal assembly)
- weight 0,53 kg



### Product dimensions

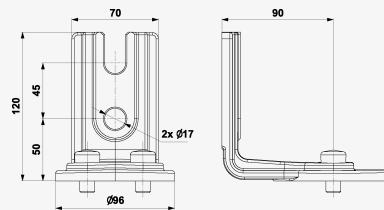

Parameter name	Parameter value
Customs tariff number	85301000
EAN	8595090566908
Order number	A06690