

# SLP-PV170 V/U S

## SPD - for DC and PV / SPD PV type 2 / MOV

Surge arrester for PV systems (both poles)

pluggable module, visual fault signalling, module locking, remote fault signalling

- varistor surge arrester in 'U' connection
- for protection of PV systems where the separating spark-over distance is kept or without LPS
- maximum continuous operating voltage for PV application:  $U_{CPV} \geq 1.2 \times U_{OC\ STC}$



Product dimensions

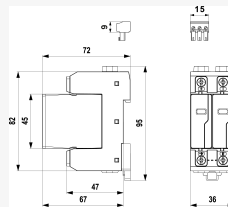

Basic circuit diagram

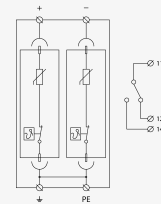

Parameter name	Parameter value
Type of SPD	PV T2
Mounting	DIN rail 35 mm
Maximum operating voltage mode +/-PE, -/PE	$U_{CPV}$ 170.00 V DC
Short-circuit current rating	$I_{SCPV}$ 10 000 A DC
Residual current mode +/-PE, -/PE	$I_{PE}$ 0.280 mA AC
Residual current mode +/-PE, -/PE	$I_{PE}$ 0.005 mA DC
Total discharge current (8/20 $\mu$ s)	$I_{Total(8/20)}$ 80.00 kA
Nominal discharge current (8/20 $\mu$ s)	$I_n$ 15.00 kA
Maximum discharge current (8/20 $\mu$ s)	$I_{max}$ 40.00 kA
Voltage protection level mode +/-	$U_p$ 1.20 kV
Voltage protection level mode +/-PE, -/PE	$U_p$ 0.60 kV
Response time	$t_a$ 25 ns
Cross-section of connected conductors solid (min)	1.00 mm <sup>2</sup>
Cross-section of connected conductors solid (max)	35.00 mm <sup>2</sup>
Cross-section of connected conductors stranded (min)	1.00 mm <sup>2</sup>
Cross-section of connected conductors stranded (max)	25.00 mm <sup>2</sup>

Cross-section of remote indication conductors solid (max)	1.5 mm <sup>2</sup>
Cross-section of remote indication conductors stranded (max)	1.5 mm <sup>2</sup>
Fault indication	red indication field
Remote indication	potential-free change-over contact
Remote indication contacts	250V/0,5A AC,250V/0,1A DC
Degree of protection	IP 20
Range of ambient temperatures (min/max)	-40 / 80 °C
According to standard	EN 61643-31, IEC 61643-31
ETIM Class	EC000941
Plug module	SLP-PV170U V/0
Customs tariff number	85363030
EAN	8595090536635
Order number	A03663

SALTEK s.r.o., Drážďanská 561/85, 400 07 Ústí nad Labem, CZ | +420 475 655 511 | [info@saltek.cz](mailto:info@saltek.cz) | [www.saltek.eu](http://www.saltek.eu)

Technická podpora: 800 818 818 | [podpora@saltek.cz](mailto:podpora@saltek.cz)

31.03.2025 -  
12:04:36